

# Model 897 Operating Tutorial

## Alternators



- Make sure that your 897 is connected to a **110VAC, 20A dedicated circuit**.
- We recommend using a Square D “**HOM120HM**” or equivalent circuit breaker.
- Be certain that both the “**Master**” and “**Motor**” switches are both on before beginning operation.

# Alternator Testing

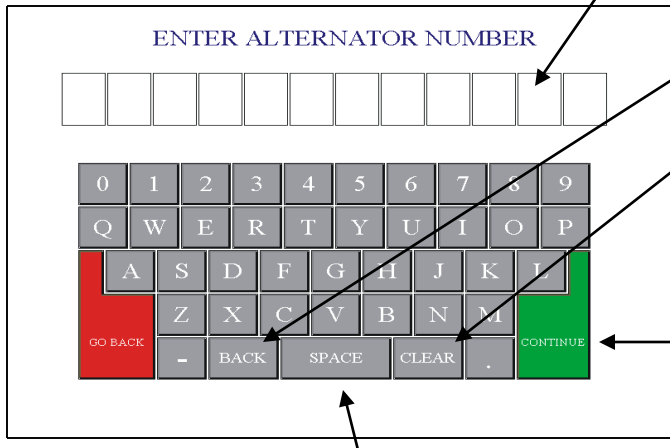
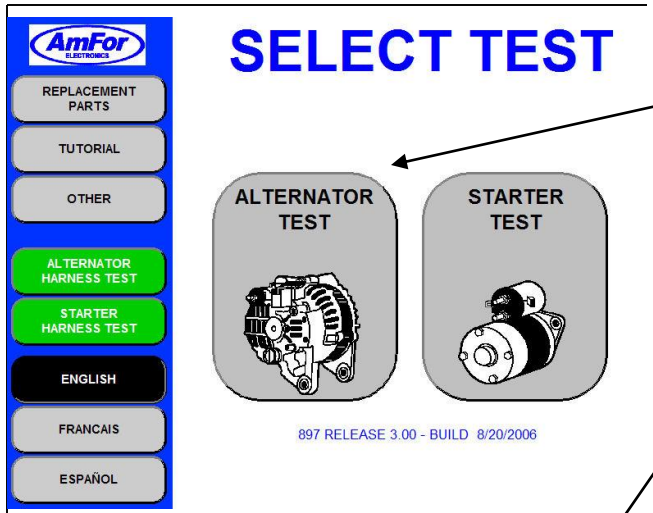

- Touch the **Alternator Test** button on the **Select Test** screen.
- Enter the alternator part number on the **Enter Alternator Number** screen. Make certain that you use the number 0 and not the letter O when entering. Make sure you enter the complete number.
- If you make an error in entry, use the **Back** to go back one space.
- **Clear** to erase entire entry.
- **Space** to enter a required space.
- Touch **Continue** to enter part number and proceed with test.

# Alternator Testing

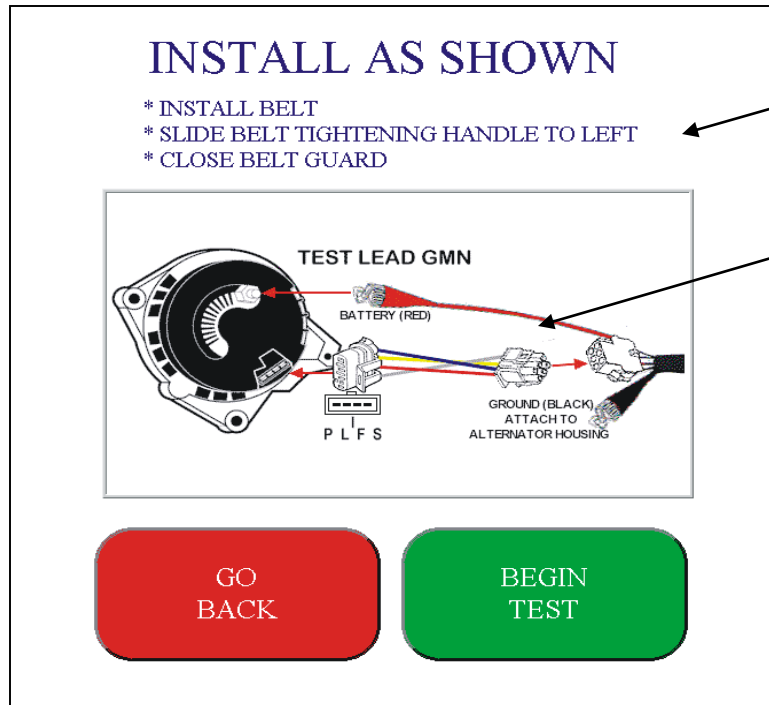

- Once you enter the part number the **Install as Shown** screen will be displayed.
- This screen also tells you which **test lead** is required.
- See the following pages for correct mounting and hook up procedures.

# Alternator Testing

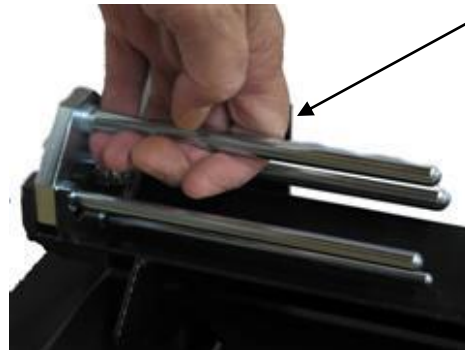
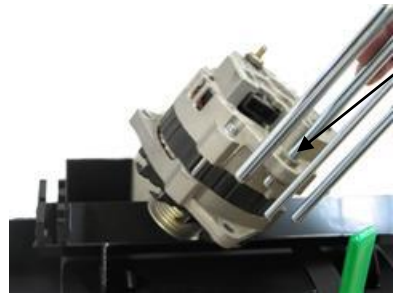
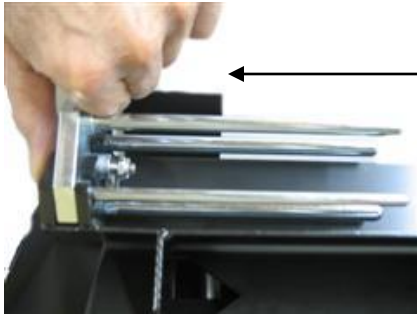

- Remove alternator turret from cradle by depressing the spring lock as shown.
- Select the correct mounting pin by inserting the largest pin that will fit into the alternator mounting hole. If the alternator being tested is a solid mount unit, use the correct mounting adapter as illustrated. Follow the paper instructions provided with each bracket.
- Replace alternator turret onto cradle by holding the correct pin up and depressing the spring lock.
- Make sure that the turret is locked in place by lifting straight up.

# Alternator Testing

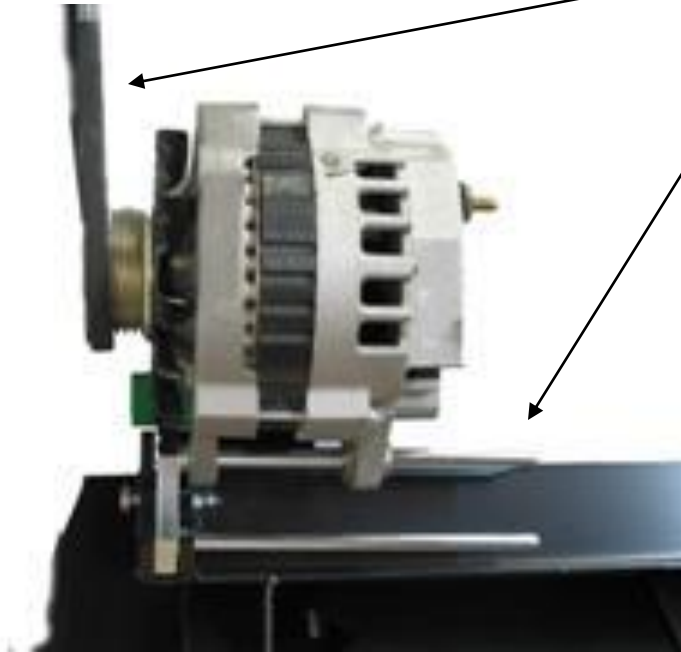

- Slide the alternator onto the turret and install belt.
- **NOTE: A different sized belt may be required to test accurately. Use the shortest belt possible.**

# Alternator Testing

- Find and install the correct alternator test lead.



# Alternator Testing

- Tighten the belt by sliding the handle to the left and lock in place.

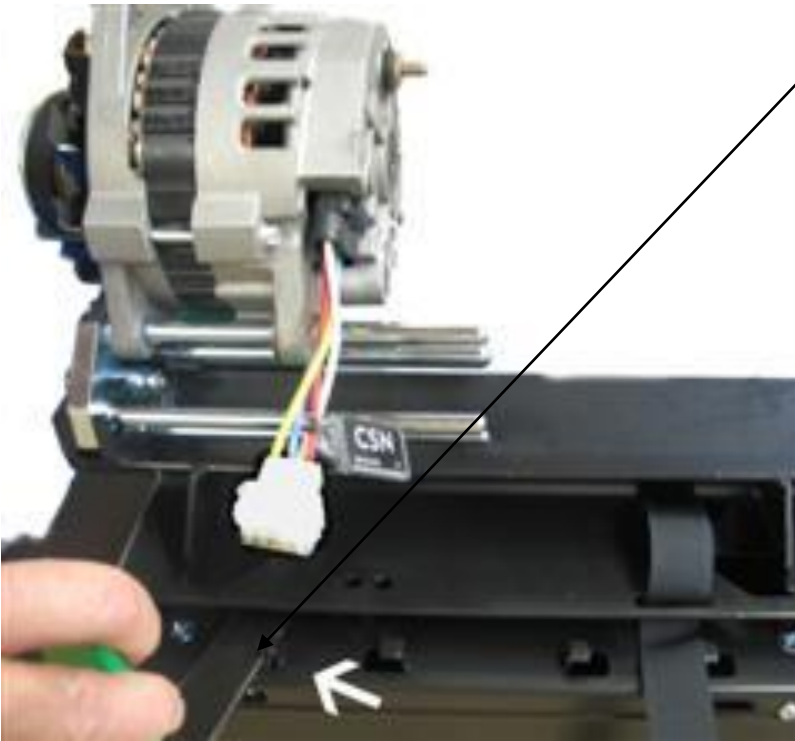

# Alternator Testing

- Plug the alternator main harness into the test lead and connect the Battery and Ground as illustrated. **Make sure the Ground wire is connected to the alternator frame and not to the turret or any plated hardware.**

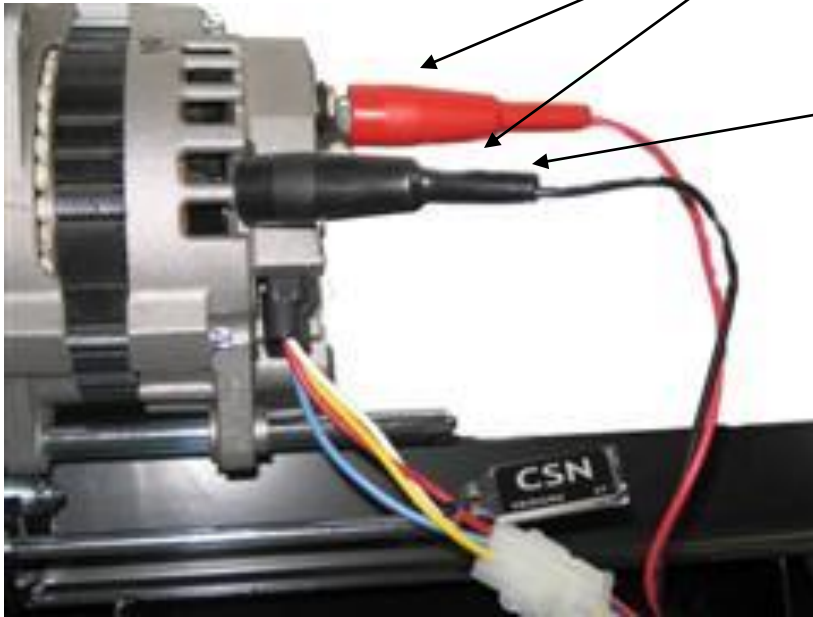



# Alternator Testing



- Close the belt guard. **The motor will not spin if the guard is open.**

# Alternator Testing

## INSTALL AS SHOWN

- \* INSTALL BELT
- \* SLIDE BELT TIGHTENING HANDLE TO LEFT
- \* CLOSE BELT GUARD

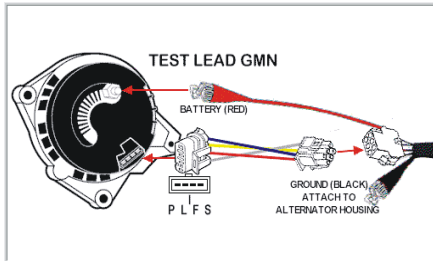

## WHAT TYPE OF UNIT IS THIS?



- Touch the **Begin Test** button.
- You will have a screen displayed asking you whether the unit being tested is a **Customers Unit, Replacement Unit, or Warranty Unit**. Touch the appropriate button and then touch **OK** to proceed. **This information is stored in the tester and does not affect the results in any way.**
- Answer any prompts that are displayed and the test will begin.

# Alternator Testing

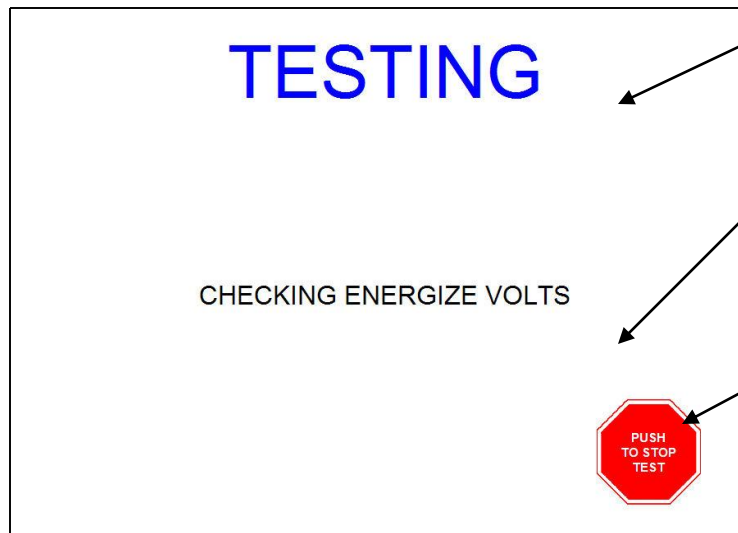

- While the test is performed the **Testing** screen will display some of the testing points.
- The test will last approximately 30 seconds.
- You may touch the **STOP** button at any time during the test. This will immediately stop the test.

# Alternator Testing

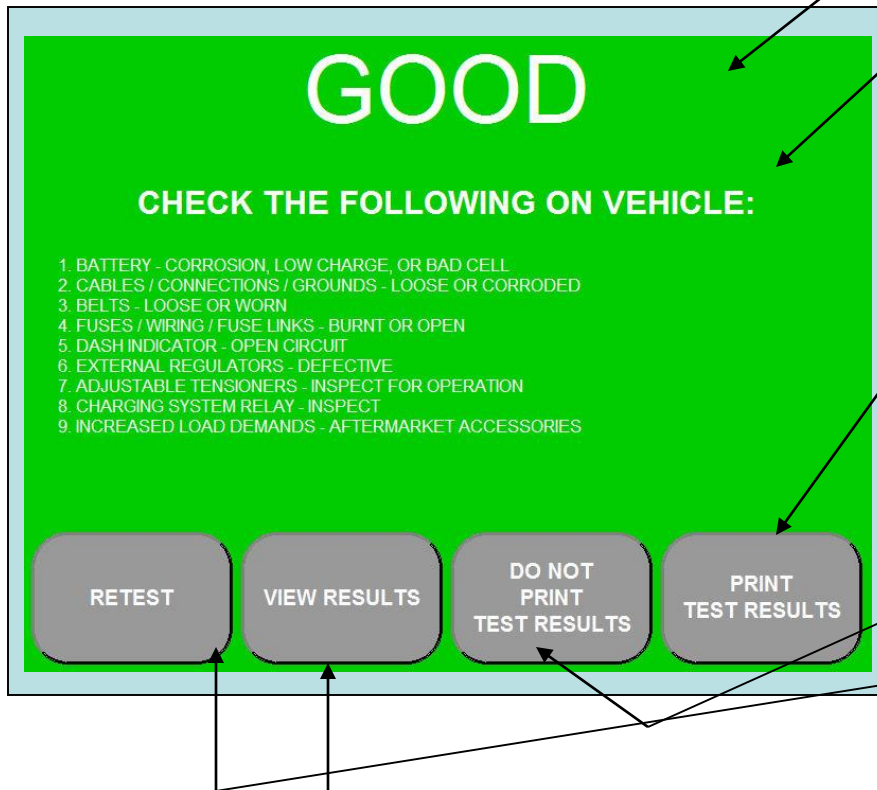

- If the unit being tested passes the test, a **GOOD** screen will be displayed.
- Other related charging system issues will also be listed for your customer.
- If you have a printer attached to the tester and wish to print the test results, touch the **Print Test Results** button. A screen will ask you if you want to add any comments. Follow the prompts to add or not add. Your results will automatically print.
- If you do not have a printer attached or you simply do not want a print out, touch the **Do Not Print Test Results** button. The test is complete.
- You may retest the unit by touching the **Retest** button.
- You may view the voltage readings of this test by touching the **View Results** button.

# Alternator Testing

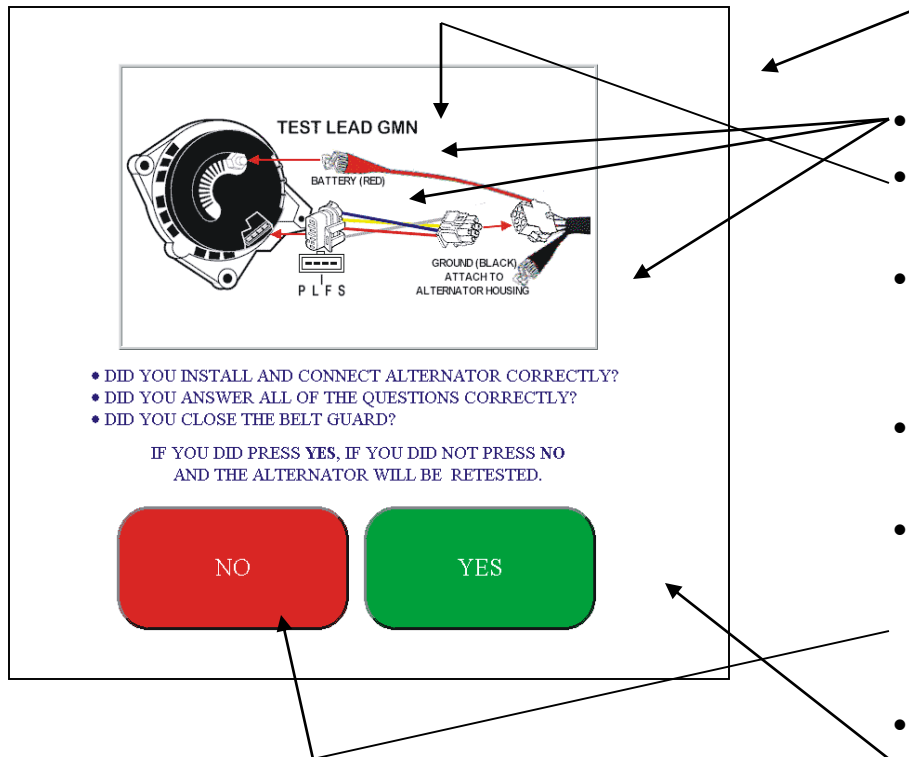

- If the unit being tested does not pass all the testing parameters, a **Did You Install Correctly** screen will be displayed.
- Double check **all** of your connections
- Verify that you are using the **correct** test lead.
- Make sure the belt is installed and tight. A slipping belt will **not** make a squealing sound.
- Make sure that the belt guard is **completely** closed.
- If you determine that anything was incorrect, make the corrections and touch the **No** button. The alternator will automatically retest.
- If you are sure that these things are correct, touch the **Yes** button. The test will proceed.

# Alternator Testing

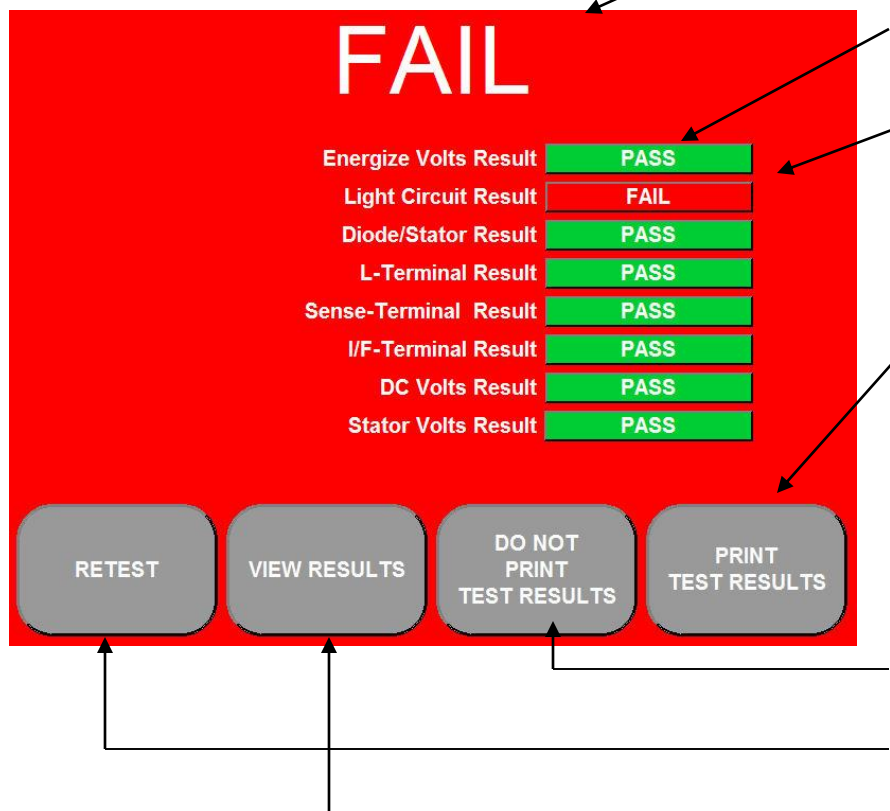

- If you have touched the **Yes** button on the previous screen, the **FAIL** screen will display. All of the possible test parameters are listed. The tester will **stop** the test at the **first** point of failure. There are three possible results that will be displayed.
- **PASS** means that this portion of the test was good.
- **FAIL** means that this portion of the test was not good.
- **N/T** means that this portion of the test was not tested.
- If you have a printer attached to the tester and wish to print the test results, touch the **Print Test Results** button. A screen will ask you if you want to add any comments. Follow the prompts to add or not add. Your results will automatically print.
- If you do not have a printer attached or you simply do not want a print out, touch the **Do Not Print Test Results** button. The test is complete.
- You may retest the unit by touching the **Retest** button.
- You may view the voltage readings of this test by touching the **View Results** button.

# Alternator Testing

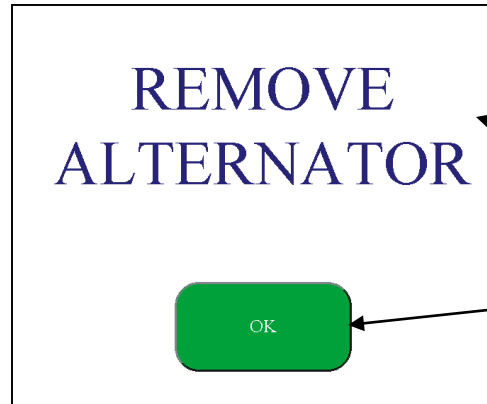

- The test is now complete.
- The **Remove Alternator** screen will flash and display for a few seconds or touch the **OK** button.
- The tester will return to the **Select Test** screen and be ready for the next test.

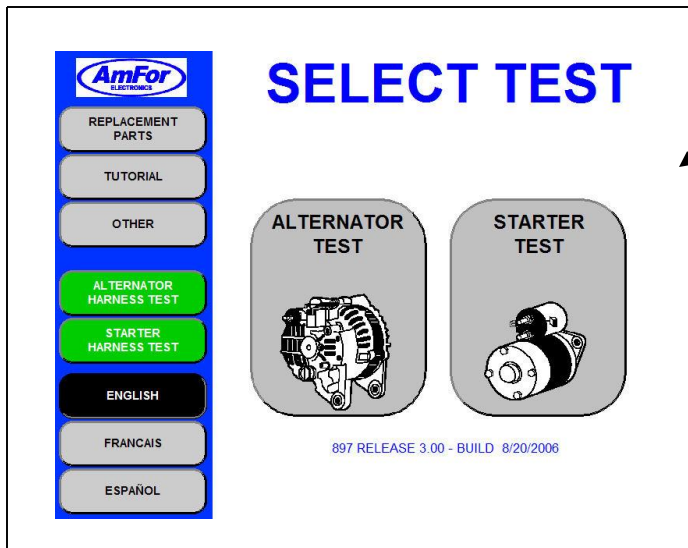

# Model 897 Operating Tutorial

## Starters



- Make sure that your 897 is connected to a **110VAC, 20A dedicated circuit**.
- We recommend using a Square D “**HOM120HM**” or equivalent circuit breaker.
- Be certain that both the “**Master**” and “**Motor**” switches are both on before beginning operation.



# Starter Testing

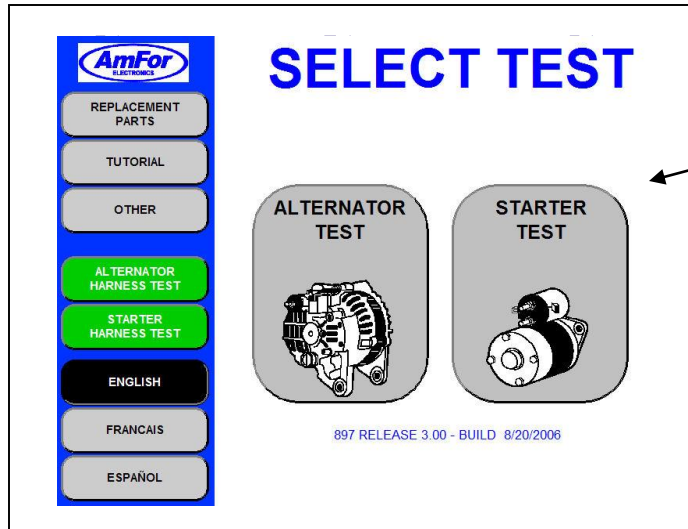

- Touch the **Starter Test** button on the **Select Test** screen.
- Enter the starter part number on the **Enter Starter Number** screen. Make certain that you use the number 0 and not the letter O when entering. Make sure you enter the complete number.
- If you make an error in entry, use the **Back** to go back one space.
- **Clear** to erase entire entry.
- **Space** to enter a required space.
- Touch **Continue** to enter part number and proceed with test.

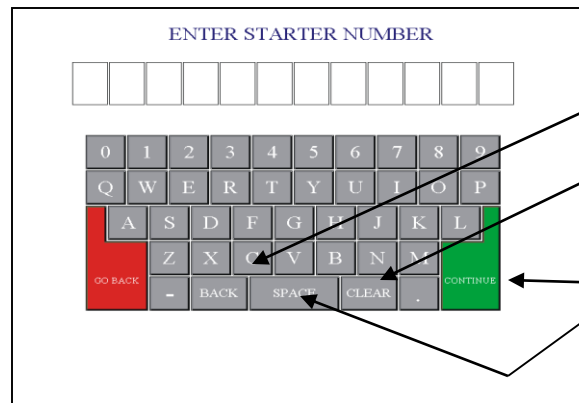

# Starter Testing

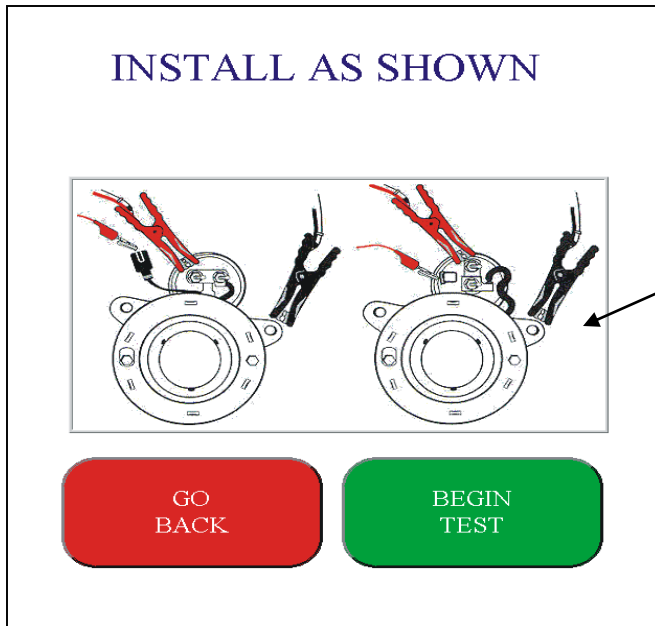

- Once you enter the part number the **Install as Shown** screen will be displayed.
- This screen also shows you a generic version of the starter for hook up assistance.
- See the following pages for correct mounting and hook up procedures.

# Starter Testing

- Remove the alternator mounting turret from the cradle.



# Starter Testing

- Lay starter in the cradle and use starter strap to tighten in place.

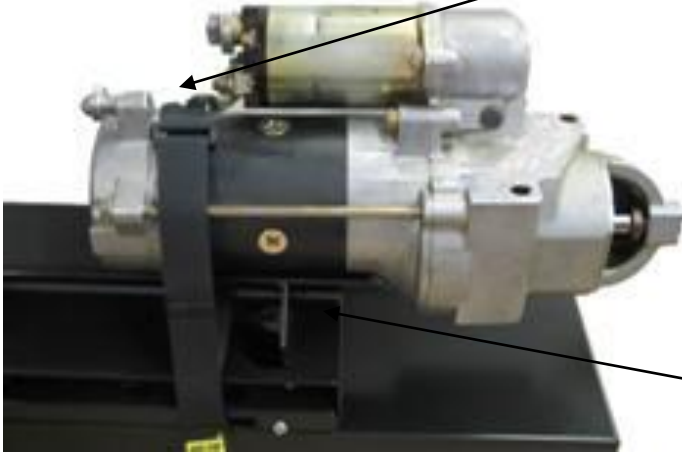

# Starter Testing

- Hook the Starter Battery cable to the starter battery connection.

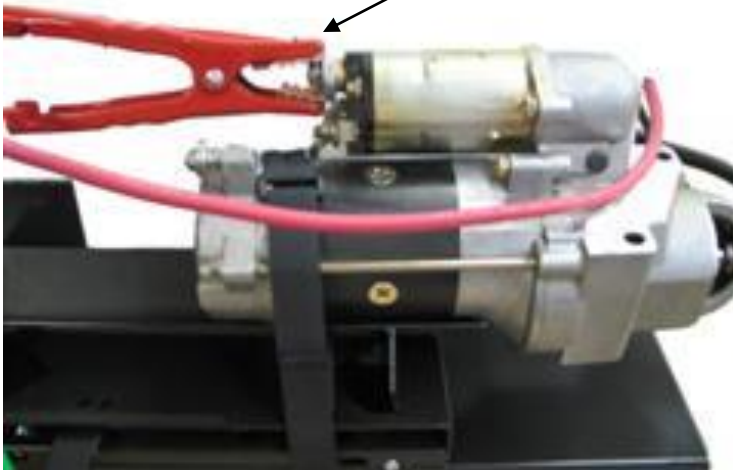

# Starter Testing

## “S” Terminal

- Hook the small red alligator clip wire to the solenoid “S” terminal. If there is not a solenoid attached to the starter, skip this step.



# Starter Testing

- Hook the Starter Ground cable to a non painted clean ground point on the starter.

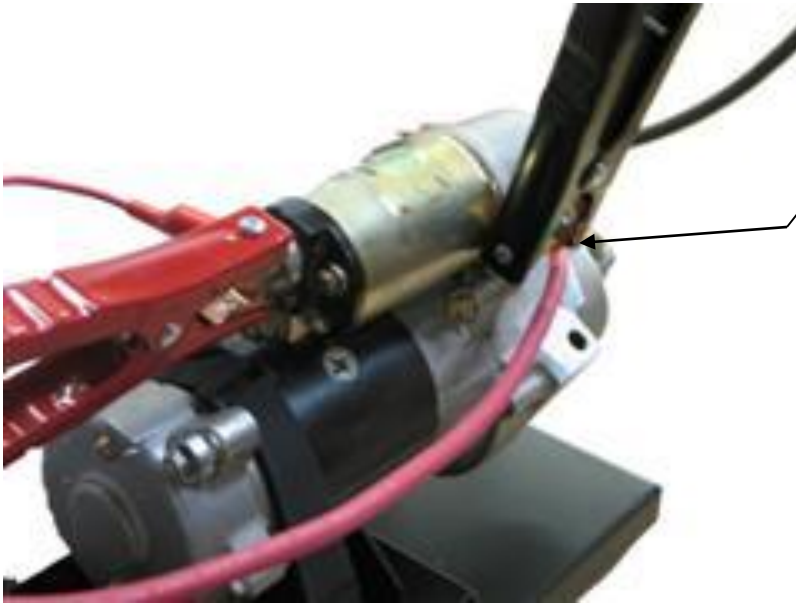

# Starter Testing

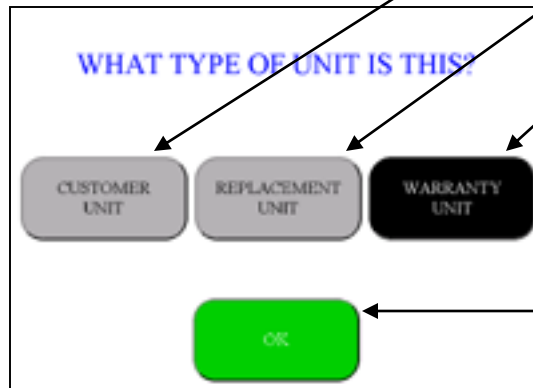
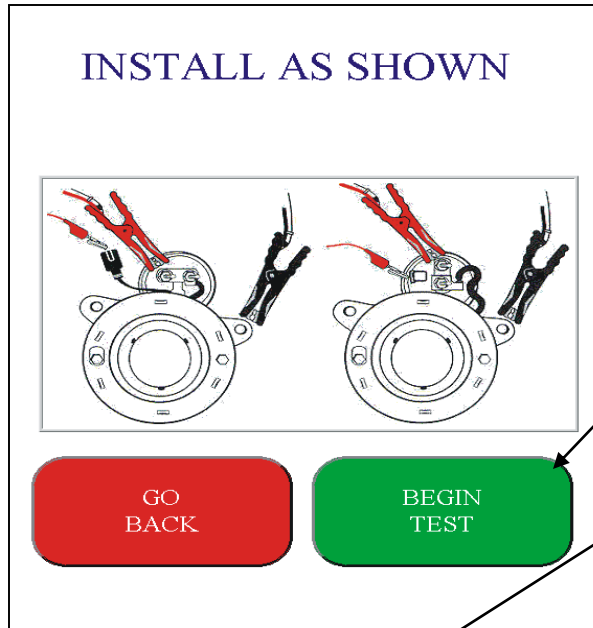

- Touch the **Begin Test** button.
- You will have a screen displayed asking you whether the unit being tested is a **Customers Unit, Replacement Unit, or Warranty Unit**. Touch the appropriate button and then touch **OK** to proceed.
- **This information is stored in the tester and does not affect the results in any way.**
- Answer any prompts that are displayed and the test will begin



# Starter Testing

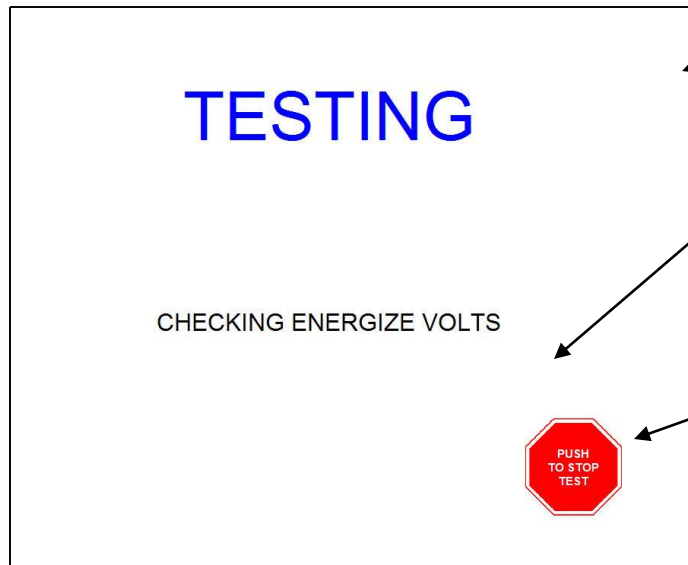

- While the test is performed the **Testing** screen will display some of the testing points.
- The test will last approximately 5 seconds.
- You may touch the **STOP** button at any time during the test. This will immediately stop the test.

# Starter Testing

DID THE STARTER DRIVE EXTEND  
AND SPIN RAPIDLY DURING THE TEST?

NO YES

DO NOT KNOW

RETEST

The image shows a screenshot of a testing interface. At the top, a question is displayed in blue text: 'DID THE STARTER DRIVE EXTEND AND SPIN RAPIDLY DURING THE TEST?'. Below the question are three buttons: a red button labeled 'NO', a green button labeled 'YES', and a grey button labeled 'RETEST'. Above the 'RETEST' button is the text 'DO NOT KNOW' in blue. Four arrows originate from the text on the right and point to the question, the 'NO' button, the 'YES' button, and the 'RETEST' button.

- After the starter is tested in a free run mode a “**Did the Drive Extend**” screen will be displayed.
- Touch the appropriate, **Yes or No**, button to answer the question.
- If you do not know, press the **Retest** button and the starter will retest **automatically**.

# Starter Testing

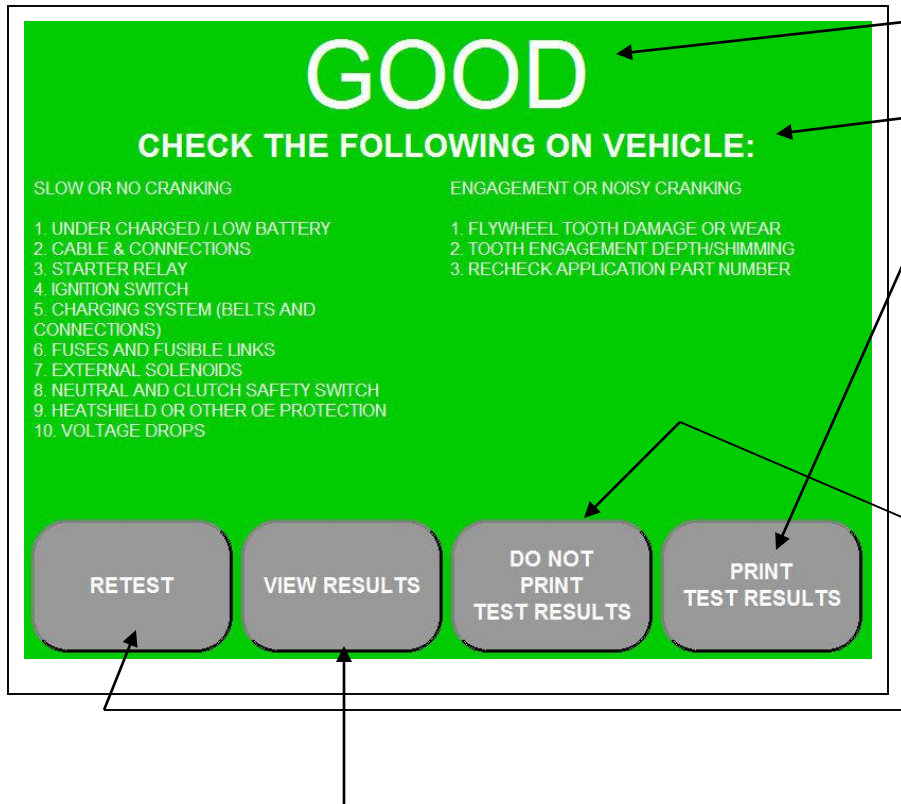

- If the unit being tested passes the test, a **GOOD** screen will be displayed.
- Other related starting system issues will also be listed for your customer.
- If you have a printer attached to the tester and wish to print the test results, touch the **Print Test Results** button. A screen will ask you if you want to add any comments. Follow the prompts to add or not add. Your results will automatically print.
- If you do not have a printer attached or you simply do not want a print out, touch the **Do Not Print Test Results** button. The test is complete.
- You may retest the unit by touching the **Retest** button.
- You may view the voltage readings of this test by touching the **View Results** button.

# Starter Testing

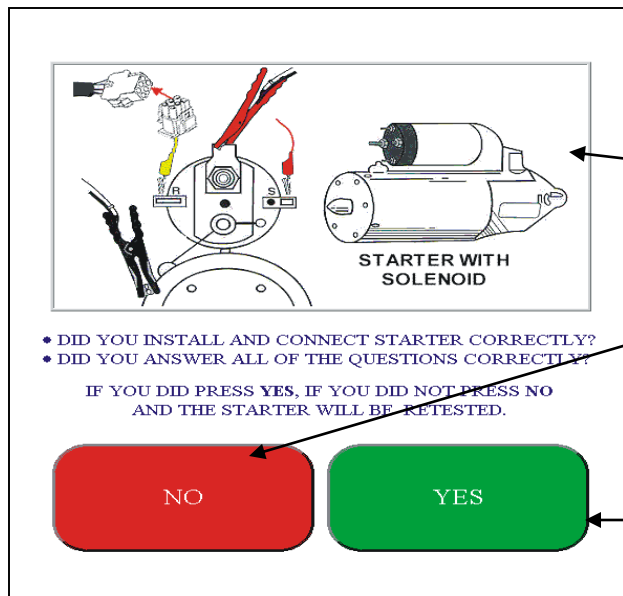

- If the unit being tested does not pass all the testing parameters, a **Did You Install Correctly** screen will be displayed.
- Double check **all** of your connections
- If you determine that anything was incorrect, make the corrections and touch the **No** button. The starter will automatically retest.
- If you are sure that these things are correct, touch the **Yes** button. The test will proceed.

# Starter Testing

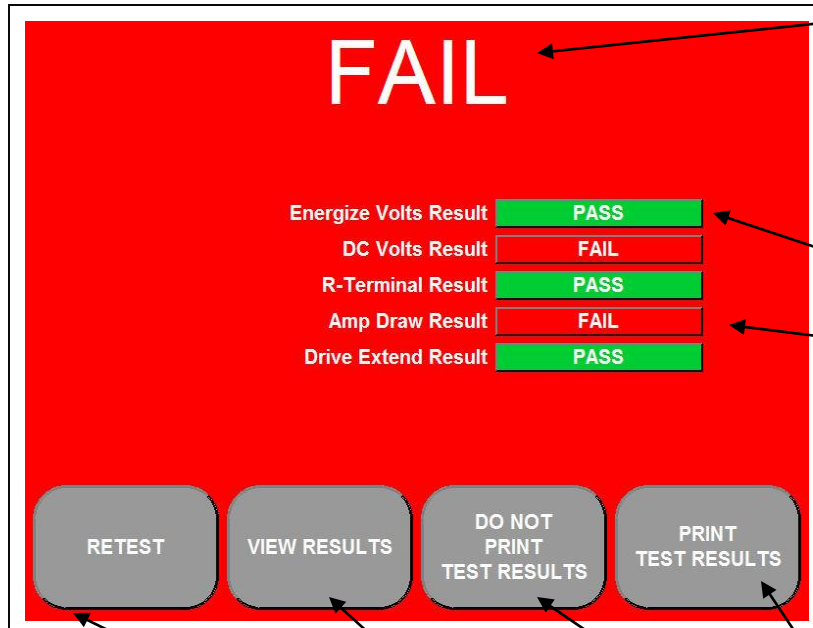

- If you have touched the **Yes** button on the previous screen, the **FAIL** screen will display. All of the possible test parameters are listed. The tester will **stop** the test at the **first** point of failure. There are three possible results that will be displayed.
- **PASS** means that this portion of the test was good.
- **FAIL** means that this portion of the test was not good.
- **N/T** means that this portion of the test was not tested.
- If you have a printer attached to the tester and wish to print the test results, touch the **Print Test Results** button. A screen will ask you if you want to add any comments. Follow the prompts to add or not add. Your results will automatically print.
- If you do not have a printer attached or you simply do not want a print out, touch the **Do Not Print Test Results** button. The test is complete.
- You may retest the unit by touching the **Retest** button.
- You may view the voltage readings of this test by touching the **View Results** button.

# Starter Testing



- The test is now complete.
- The **Remove Starter screen** will flash and display for a few seconds or touch the **OK** button.
- The tester will return to the **Select Test** screen and be ready for the next test.

